

MONUMENTING STREET INTERSECTIONS WHERE CURB AND GUTTERS ARE INSTALLED

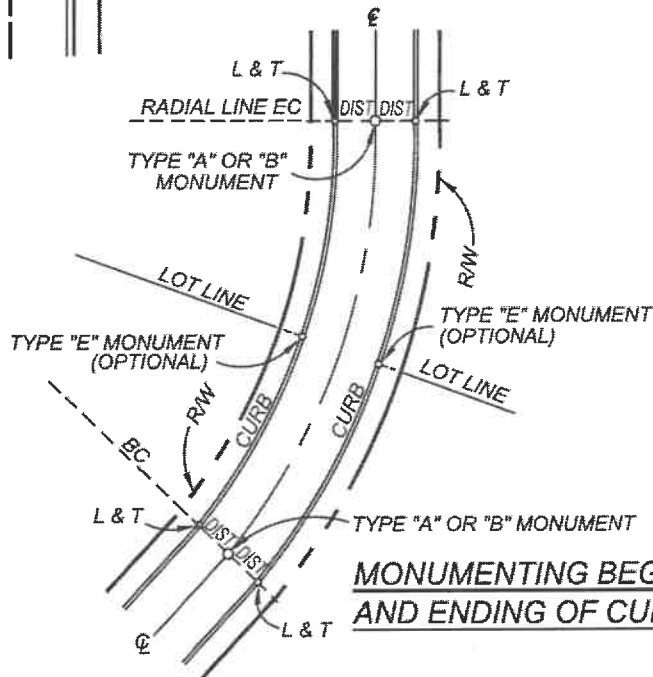

MONUMENTING BEGINNING AND ENDING OF CURVE

NOTES:

- 1.) L & T SHOWN HEREON INDICATES LEAD AND TACK OR STEEL PIN MONUMENT SET IN CONCRETE CURB.
- 2.) LEAD AND TACK OR STEEL PIN MONUMENT WITNESS TO PROPERTY CORNER MAY BE SET ("E" MONUMENT) IN LIEU OF SETTING FRONT LOT CORNERS.
- 3.) THE PI OF THE CURVE C OF A STREET MAY BE MONUMENTED IN LIEU OF EC AND BC IF THE PI FALLS WITHIN THE TRAVELED WAY. IT SHALL BE REFERENCED WITH L & T's IN CURB.
- 4.) SEE STD MVS1-170B AND MVS1-170E FOR TIE-OUT/MONUMENT NOTES.

NOT TO SCALE



RECOMMENDED:
M.D.L. 7/2/19
 DIVISION MANAGER DATE
 APPROVED:
M.L. Wolfe 7/30/19
 PUBLIC WORKS DIRECTOR / DATE
 CITY ENGINEER

CITY OF MORENO VALLEY
 PUBLIC WORKS DEPARTMENT - LAND DEVELOPMENT DIVISION

**STREET CENTERLINE
 MONUMENT**

STANDARD PLAN
MVSI-170D-0

SHEET 4 OF 5