

City of Moreno Valley

Community Facilities District No. 2014-01 (Maintenance Services)

Special Districts Division
Public Works Department

Annual Special Tax Report

2019/20

Report Date: April 2019

14177 Frederick Street
PO Box 88005
Moreno Valley, CA 92552
specialdistricts@moval.org
951.413.3480



TABLE OF CONTENTS

I. INTRODUCTION	1
A. Description of Proceedings	1
B. The District.....	2
i. Boundaries of the District.....	2
ii. Boundaries of the Future Annexation Area.....	2
iii. Future Annexations	2
iv. Description of Services	2
II. CFD NO. 2014-01 FUNDED FACILITIES	4
III. COMPUTATION OF THE SPECIAL TAX REQUIREMENT.....	5
A. Annual Escalation Factor	5
B. Maintenance and Operation Services	5
C. Administrative Expenses.....	5
D. Reserve Fund	6
E. Special Tax Requirement.....	6
IV. SPECIAL TAX CALCULATION.....	7
A. Rate and Method of Apportionment	7
B. Tax Rate Area	7
C. Special Tax Rate.....	7
D. Method of Apportionment.....	8
E. Delinquencies	9
V. SPECIAL TAX ALLOCATION (TAX ROLL)	10
Appendix A: Annexations	A-1
Appendix B: District Maps	B-1

TABLES

Table 1: Summary of Actions.....	1
Table 2: Facilities	4
Table 3: Annual Escalation	5
Table 4: Special Tax Requirement.....	6
Table 5: Special Tax Rates	8
Table 6: Delinquencies	9
Table 7: Special Tax Allocation.....	10
Table 8: Annexations	A-1

LIST OF PARTICIPANTS

Community Facilities District No. 2014-01

City Contacts

Michael L. Wolfe, P.E.
Public Works Director/City Engineer
14177 Frederick Street
P.O. Box 88005
Moreno Valley, CA 92552-0805
951.413.3100
michaelw@moval.org

Candace E. Cassel
Special Districts Division Manager
14177 Frederick Street
P.O. Box 88005
Moreno Valley, CA 92552-0805
951.413.3480
candacec@moval.org

Special Legal Counsel

Mark E. Mandell, Esq.
Mandell Municipal Counseling
310.274.8921
Mark@MandellMuni.com

Special Tax Consultant

Jim McGuire
Principal Consultant
Willdan Financial Services
27368 Via Industria, Suite 110
Temecula, CA 92590
951.587.3500
McGuiJ@willdan.com

I. INTRODUCTION

This Annual Special Tax Report is prepared in compliance with Section 53343.1 of the Mello-Roos Community Facilities Act of 1982 (Government Code Section 53311 et seq.) (the “Act”) for the City of Moreno Valley Community Facilities District No. 2014-01 (Maintenance Services).

A. DESCRIPTION OF PROCEEDINGS

The City Council of the City of Moreno Valley formed the City of Moreno Valley Community Facilities District No. 2014-01 (“CFD No. 2014-01,” “District”, or “CFD”) to fund maintenance services related to parkway and median landscaping and street lighting. The District was established under the authority of the Act. Property owners whose new development projects have been approved with the condition of providing an ongoing funding source for 1) landscape maintenance and/or 2) street lighting services can annex into the District. By annexing into the District, a qualified elector (i.e. property owner or registered voter) authorizes the City to levy the special tax on their property tax bill. Revenue received from the special tax funds the specified services. The following table provides a summary of the actions taken in the formation of the District and subsequent amendments to the rate and method of apportionment of the special tax (RMA).

Table 1: Summary of Actions

Document	Number	Date
Resolution of Intention to Establish the District	2014-12	February 11, 2014
Resolution Establishing the District and Calling for a Special Election	2014-25	March 25, 2014
Resolution Declaring the Results of the Special Election	2014-26	March 25, 2014
Ordinance Authorizing the Levy of a Special Tax	874	April 8, 2014
Resolution Declaring Intention to Provide for Future Annexation of Territory to the District and to Amend and Restate the RMA for the District to Designate Tax Rate Areas No. LM-01 and SL-01	2014-73	August 26, 2014
Public Hearing for the First Amended and Restated RMA		October 14, 2014
Ordinance Providing for Future Annexation of Territory to the District and to Amend and Restate the RMA for the District to Designate Tax Rate Areas No. LM-01 and SL-01	882	October 28, 2014
Resolution Declaring Intention to Provide for Future Annexation of Territory to the District and Amend and Restate the RMA for the District to Designate Tax Rate Areas No. LM-02 And SL-02 and Revise the Rate Structure for Tax Rate Area No. LM-01	2014-100	December 9, 2014
Public Hearing for the Second Amended and Restated RMA		January 27, 2015
Ordinance Providing for Future Annexation of Territory to the District and Amend and Restate the RMA for the District to Designate Tax Rate Areas No. LM-02 And SL-02 and Revise the Rate Structure for Tax Rate Area No. LM-01	889	February 10, 2015

B. THE DISTRICT

The City Council formed CFD No. 2014-01 in 2014 to provide funding for maintenance services related to parkway and median landscaping and street lighting.

i. BOUNDARIES OF THE DISTRICT

The parcels located within Tract 31618 are the original boundaries of the CFD. Since its formation, additional property owners have annexed their development into the District. Appendix A lists the annexations into the District, by development, as of the date of this report. The map of the District's Boundary and the boundaries of the future annexation area is included in Appendix B. Also included are map amendments identifying each of the annexations.

ii. BOUNDARIES OF THE FUTURE ANNEXATION AREA

Aside from the territory that formed the District when the future annexation area was established, the boundaries of the future annexation area encompass the City boundary at the time the District was formed. While all parcels in the City at the time of District formation are included in the District boundaries, qualified electors must approve the annexation to the District and approve the maximum special tax for any applicable Tax Rate Area(s) prior to the special tax being levied against the property.

iii. FUTURE ANNEXATIONS

The future annexation area permits property owners, at the discretion of the City Council, to annex their property to the CFD and approve the Tax Rate Area(s) set forth in the RMA applicable to their development in an expedited manner.

As a condition of approval for their development, property owners are required to provide a funding source to support the maintenance and operation of public landscaping and/or street lights installed by the development. The property owner may either 1) annex into the District and authorize the levy of a special tax to be placed on their property tax bill to fund the service(s) or 2) form a Home or Property Owners Association to provide the required ongoing maintenance for the project's improvements.

iv. DESCRIPTION OF SERVICES

The services ("Services") described below are proposed to be funded by the CFD. Nothing in this description of services or any Resolution of the City Council shall be construed as committing the City or the CFD to provide all of the authorized Services. The provision of Services shall be subject to the availability of sufficient proceeds of special taxes within each Tax Rate Area of the CFD.

These Services are in addition to those provided in the territory within the CFD prior to the establishment of the CFD and such Services will not supplant services already available within the CFD. Not all of the listed services are provided to every parcel in the CFD. The actual services provided depend on the Tax Rate Area(s) to which the parcel is assigned.

Additional services may be provided to territory annexed to the CFD in the future. Services provided in territory annexed to the CFD in the future may or may not include landscape maintenance services or street lighting services as described below.

Landscape Maintenance Services

Maintaining, servicing and operating landscape improvements and associated appurtenances located within the public right-of-way and within dedicated landscape easements for the CFD. These improvements may include but are not limited to parkways, medians, open space landscaping, fencing, monuments, ornamental lighting, drainage, turf, ground cover, shrubs, vines and trees, irrigation systems, and appurtenant facilities and structures. Fundable costs may include, but are not limited to: (i) contracting costs for landscape maintenance services, including litter removal, (ii) salaries and benefits of City staff, (iii) expenses related to equipment, apparatus, and supplies related to these services, (iv) City administrative and overhead costs associated with providing such services within the CFD, and (v) lifecycle costs associated with the repair and replacement of facilities.

Street Lighting Services

Maintaining, servicing, and operating street lights and appurtenant improvements. Fundable costs may include, but are not limited to: (i) contracting costs for street light maintenance, (ii) salaries and benefits of City staff, if the City directly provides street light maintenance services, (iii) utility expenses and the expense related to equipment, apparatus, and supplies related to these services and authorized by the Act, (iv) City administrative and overhead costs associated with providing such services for the CFD, and (v) lifecycle costs associated with the repair and replacement of facilities.

II. CFD NO. 2014-01 FUNDED FACILITIES

The following summary provides a list of the various facility types, which shall be maintained through the levy and collection of special taxes from parcels in CFD No. 2014-01.

Table 2: Facilities

LANDSCAPE MAINTENANCE SERVICES

Single-Family Residential

Project Name/ Property Owner	Location	Tax Rate Area	No. of Parcels at Build Out	Sq. Ft.	Type of Improvement
Frontier Communities	TT 31618 - Southwest corner of Bay Ave and Moreno Beach Dr	LM-01(H)	55	17,928	Parkway
KB Homes	TT 36436 - Quincy Channel, between Brodiaea Ave and Cactus Ave	LM-01(I)	159	69,990	Parkway
RSI Communities	TT 22180 - Northwest corner of Gentian Ave and Perris Blvd	LM-01(G) ¹	140	34,618	Parkway & Median
RSI Communities	TT 31305 - West side of Nason St, between Fir Ave and Eucalyptus Ave	LM-01(K) ²	86	50,851	Parkway & Median
KB Home Coastal Inc	TT 24203 - East side of Pigeon Pass Rd, north of Lawless Rd	LM-01(C)	97	3,839	Parkway

¹ Landscape square footages were updated after plan check was completed. This development was re-categorized to Maintenance Category G starting FY 2019/20.

² Landscape plans were submitted after the rates were calculated for FY 2017/18. This development was re-categorized to Maintenance Category K starting FY 2018/19.

Properties Other than Single-Family Residential

Project Name/ Property Owner	Location	Tax Rate Area	No. of Parcels at Build Out	Sq. Ft.	Type of Improvement
March Business Center	Southeast corner of Iris Avenue and Heacock Street	LM-02A	4	2,660	Median
Duke Realty	Northeast corner of Iris Ave and Heacock St	LM-02A	1	4,706	Median
The Quarter Retail Center	Northeast corner of Eucalyptus Ave and Day St	LM-02A	6	0	None
Cactus Commerce Center	Northeast corner of Cactus Ave and Commerce Center Dr	LM-02A	3	TBD	Median
Duke Realty LTD Partnership	Southwest corner of Nandina Ave and Perris Blvd	SL-02	1	3,934	Median
First Industrial	Southwest corner of San Michele Rd and Perris Blvd	LM-02B	1	285 ³	Median
L. Valenzuela	Northwest corner of Frederick St and Alessandro Blvd	LM-02B	1	91 ³	Median
Kearny Modular	Northeast corner of Modular Way and Perris Blvd	LM-02B	2	271 ³	Median
Supreme Truck	Southwest corner of Alessandro Blvd and Grant St	LM-02B	1	496 ³	Median
Duke Realty Limited Partnership	Northwest corner of San Michele Rd and Perris Blvd	LM-02B	1	330 ³	Median

³ Proportional Front Footage of Adjacent Median

STREET LIGHTING SERVICES

Single-Family Residential

Project Name/ Property Owner	Location	Tax Rate Area	No. of Parcels at Build Out	Qty 9,500 Lumen	Qty 22,000 Lumen
Frontier Communities	TT 31618 - Southwest corner of Bay Ave and Moreno Beach Dr	SL-01	55	24	4
Habitat for Humanity, Inc.	TT 36598 - South side of Myers Ave east of Indian St	SL-01	8	3	0
GFR Enterprises	TT 31789 - South of Ironwood Ave, east of Lasselle St	SL-01	24	6	1
KB Homes	TT 36436 - Quincy Channel, between Brodiaea Ave and Cactus Ave	SL-01	159	52	7
CV Communities	TT 31592 - East of Perris Blvd, north of Manzanita Ave	SL-01	114	63	0
FH II	TT 36882 - South side of Brodiaea Ave, west of Moreno Beach Dr	SL-01	40	13	0
Metric Homes	TT 35606 - Metric Dr, on the west side of Perris Blvd, east of Hubbard St	SL-01	16	5	1
JW Capital PP	TT 29343 - West of Hidden Springs Dr between Green Ridge Dr and Pigeon Pass Rd	SL-01	58	18	0
RSI Communities	TT 22180 - Northwest corner of Gentian Ave and Perris Blvd	SL-01	140	39	30
Beazer Homes	TT 36933 - South side of Eucalyptus Ave east of Fir Ave	SL-01	274	TBD	TBD
RSI Communities	TT 31305 - West side of Nason St, between Fir Ave and Eucalyptus Ave	SL-01	86	31	0
Metric Homes	TTM 31621 - East of Hubbard St and Tranquil Way	SL-01	12	8	0
KB Home Coastal Inc	TT 24203 - East side of Pigeon Pass Rd, north of Lawless Rd	SL-01	97	32	2

Properties Other than Single-Family Residential

Project Name/ Property Owner	Location	Tax Rate Area	No. of Parcels at Build Out	Qty 9,500 Lumen	Qty 22,000 Lumen
RB Johnson Investments, LLC	West side of Heacock Street at Webster Avenue	SL-02	1	0	2
Les Schwab Tires	East side of Perris Blvd, north of Fir Ave	SL-02	1	0	1
FR CAL Moreno Valley	Southeast corner of San Michele Rd and Heacock St	SL-02	1	0	11
First Industrial	Southwest corner of San Michele Rd and Perris Blvd	SL-02	1	0	6
Riverview Partners, LP	South side of Box Springs Rd, east of Clark St	SL-02	1	2	3
Prologis	West of the intersection at Quincy St and Eucalyptus Ave	SL-02	5	4	24
Kearny Modular	Northeast corner of Modular Way and Perris Blvd	SL-02	2	0	12
First Industrial	Southwest corner of Nandina Ave and Indian St	SL-02	1	14	8
OM MacArthur	North side of Hemlock Ave, east of Swegles Ln	SL-02	1	TBD	TBD
Indian Commerce Center	Southwest corner of Grove View Rd and Indian St	SL-02	1	0	4
Duke Realty Limited Partnership	Northwest corner of San Michele Rd and Perris Blvd	SL-02	1	0	5
1215 PL, LLC	Southeast corner of San Michele Rd and Indian St	SL-02	1	0	9
Balwinder Kang	Southeast corner of Rivard Rd and San Celeste Rd	SL-02	1	4	0
Duke Realty LTD Partnership	Southwest corner of Nandina Ave and Perris Blvd	SL-02	1	5	2
Prologis, L.P.	Southwest corner of Krameria Ave and Indian St	SL-02	3	13	12
Arlene Hamann, et al	South side of John F. Kennedy Dr west of Perris Blvd	SL-02	1	1	0

III. COMPUTATION OF THE SPECIAL TAX REQUIREMENT

A special tax for CFD No. 2014-01 (Maintenance Services) shall be levied on all Assessor's Parcels that have been annexed into the CFD and collected each fiscal year (FY) commencing in FY 2014/15 in an amount determined by the City through the application of the RMA. All of the real property subject to the special tax, unless exempted by law or by the provisions thereof, shall be taxed for the purposes, to the extent and in the manner provided. The District is citywide; however, the special tax is only applied to those properties that have been annexed into the District at the request of the qualified electors.

A. ANNUAL ESCALATION FACTOR

On each July 1 following the year the District was established ("Base Year"), the maximum special tax rates shall be increased by the greater of the increase in the annual percentage change in the Consumer Price Index (CPI) or five percent (5%). The CPI is based on the Department of Labor, Bureau of Labor Statistics, Regional Consumer Price Index for All Urban Consumers for Los Angeles-Long Beach-Anaheim.¹

Table 3: Annual Escalation

Fiscal Year	% Change in CPI	% Used to Increase Maximum Rates
2015/16	0.73%	5.00%
2016/17	2.03%	5.00%
2017/18	1.97%	5.00%
2018/19	3.61%	5.00%
2019/20	3.24%	5.00%

B. MAINTENANCE AND OPERATION SERVICES

The District shall provide the ongoing maintenance services related to parkway and median landscaping and street lighting. Services associated with landscape maintenance and street lighting is further described in Section I.B.iv: Description of Services.

C. ADMINISTRATIVE EXPENSES

Administrative expenses are those expenses incurred by the City as administrator of the CFD to determine, levy and collect the special taxes, including salaries and benefits of City employees whose duties are related to administration of the CFD and the fees of consultants, legal counsel, the costs of collecting installments of the special taxes, preparation of required reports, and any other costs required to administer the CFD as determined by the City.

¹ In January 2018, the Bureau of Labor Statistics introduced a new geographic area sample for the CPI. Riverside, CA, which was previously included in the Los Angeles-Riverside-Orange County, CA MSA (Metropolitan Statistical Area), will now be included in a separate CBSA (Core Based Statistical Area) and will be considered a new index named Riverside-San Bernardino-Ontario, starting at 100.000. The Los Angeles-Riverside-Orange County, CA index was renamed "Los Angeles-Long Beach-Anaheim". Because the CPI approved by the qualified electors was the Los Angeles-Riverside-Orange County index, and it was renamed and not eliminated, the City Attorney determined the District would continue to use the Los Angeles-Long Beach-Anaheim index.

D. RESERVE FUND

A contingency reserve will be maintained for the District to provide for the payment of expenses until the payment of taxes is received by the County and for unexpected costs which may be incurred in the FY.

E. SPECIAL TAX REQUIREMENT

The following table sets forth a summary of the Special Tax Requirement for FY 2019/20.

Table 4: Special Tax Requirement

FY 2019/20 Estimated Costs for Community Facilities District No. 2014-01								
Landscaping								
	LM-01 (C)	LM-01 (G)	LM-01 (H)	LM-01 (I)	LM-01 (K)	LM-02 (A)	LM-02 (B)	Total
Personnel	\$ -	\$ 1,346.06	\$ 2,104.10	\$ -	\$ 1,016.96	\$ 862.00	\$ 583.25	\$ 5,912.37
Maintenance and Operation	-	6,992.02	14,475.00	-	4,896.51	17,518.00	1,688.55	45,570.08
Fixed Charges (Overhead & Administration)	-	215.32	338.00	-	163.37	139.00	10.00	865.69
Anticipated Delinquent Special Taxes (not to exceed 10% of Total Requirement)	-	219.00	219.00	386.00	1,836.00	-	-	2,660.00
Establish Operational and Repair/Replacement Reserves	796.80	-	2,500.00	9,748.66	8,250.00	1,028.78	-	22,324.24
Subtotal Landscaping Costs	\$796.80	\$8,772.40	\$19,636.10	\$10,134.66	\$16,162.84	\$19,547.78	\$2,281.80	\$77,332.38
Street Lighting								
						SL-01	SL-02	Total
Personnel						5,680.00	3,268.80	8,948.80
Maintenance and Operation						47,040.00	27,240.00	74,280.00
Fixed Charges (Overhead & Administration)						1,420.00	817.20	2,237.20
Anticipated Delinquent Special Taxes (not to exceed 10% of Total Requirement)						5,414.00	116.38	5,530.38
Establish Operational and Repair/Replacement Reserves						59.00	87.44	146.44
Subtotal Street Lighting Costs						\$59,613.00	\$31,529.82	\$91,142.82
Total FY 2019/20 Special Tax Requirement								\$168,475.20

* The budget is based on staff's recommendation and is subject to City Council approval.

The special tax is the amount necessary to pay for Services related to all Tax Rate Areas, which are in addition to the services already provided to the area, if any, before the CFD was created. The Special Tax Requirement is based on estimated expenses to fund the annual maintenance and operation for landscaping and street lights in the District.

IV. SPECIAL TAX CALCULATION

The special tax shall be collected in the same manner and at the same time as ordinary *ad valorem* property taxes; however, the CFD Administrator may directly bill the special tax or collect special taxes at a different time, if necessary, to meet the financial obligations of the District as otherwise determined appropriate by the CFD Administrator.

The special tax shall be subject to the same penalties, procedure, sale, and lien priority in any case of delinquency as applicable for ad valorem taxes.

Commencing with FY 2014/15 and for each following FY, the CFD Administrator shall, separately within each Tax Rate Area, proportionately levy the special tax on each Assessor's Parcel, whether developed or undeveloped, within that Tax Rate Area at an amount up to 100% of the applicable maximum special tax until the amount levied is equal to the Special Tax Requirement assigned to that Tax Rate Area in that FY.

A. RATE AND METHOD OF APPORTIONMENT

Since the FY 2014/15 Annual Report, the RMA has been amended in accordance with the Act on two separate occasions. The first amended and restated RMA reassigned the original Tax Rate Area No. 1 into two separate Tax Rate Areas: LM-01 for maintenance of public landscaping and SL-01 for operation of standard street lighting for single family residential developments. The second amended and restated RMA 1) added two Tax Rate Areas (LM-02 and SL-02) to fund landscape maintenance and operation of street lighting for developments other than single-family residential (i.e. commercial, industrial, and multifamily) and 2) expanded the Tax Rate table for Tax Rate Area No. LM-01 (single-family residential landscaping). The expanded tax rate table ensures equitable apportionment of the tax by providing different maximum special tax rates based on the size of the development's landscaping and number of parcels funding the service.

B. TAX RATE AREA

A Tax Rate Area is a grouping of parcels that are taxed to fund a specific service. Tax Rate Areas may be created from time to time to add additional services or service levels, and each parcel annexed to the CFD shall, at the time it is annexed, be assigned to one or more Tax Rate Area(s) by action of the City Council (with approval of the qualified electors). Tax Rate Areas are based on development plans at the time of annexation; however all taxes will be calculated as set forth in the Rate and Method of Apportionment.

C. SPECIAL TAX RATE

The Base Year (FY 2014/15) maximum special tax rates and FY 2019/20 maximum special tax and applied special tax rates are listed in the following table for each Tax Rate Area. Those Tax Rate Areas without an applied special tax have no services to fund.

Table 5: Special Tax Rates

Tax Rate Area	Maintenance Ratio	Unit of Calculation	BASE YEAR		
			FY 2014/15 Maximum Special Tax Rate	FY 2019/20 Maximum Special Tax Rate	FY 2019/20 Applied Special Tax Rate
LM-01	Single-Family Residential Landscaping	per parcel			
LM-01(A)	Less than or equal to 20 square feet per Single-Family Residential Parcel		\$ 14.19	\$ 18.09	\$ -
LM-01(B)	21 - 40 square feet per Single-Family Residential Parcel		42.58	54.31	-
LM-01(C)	41 - 70 square feet per Single-Family Residential Parcel		78.06	99.60	99.60
LM-01(D)	71 - 110 square feet per Single-Family Residential Parcel		127.73	163.00	-
LM-01(E)	111 - 160 square feet per Single-Family Residential Parcel		191.60	244.51	-
LM-01(F)	161 - 220 square feet per Single-Family Residential Parcel		269.66	344.13	-
LM-01(G)	221 - 290 square feet per Single-Family Residential Parcel		361.91	461.88	62.66
LM-01(H)	291 - 370 square feet per Single-Family Residential Parcel		468.36	597.72	357.02
LM-01(I)	371 - 460 square feet per Single-Family Residential Parcel		589.00	751.71	63.74
LM-01(J)	461 - 560 square feet per Single-Family Residential Parcel		723.83	923.80	-
LM-01(K)	561 - 670 square feet per Single-Family Residential Parcel		872.85	1,113.98	187.94
LM-01(L)	671 - 790 square feet per Single-Family Residential Parcel		1,036.07	1,322.29	-
LM-01(M)	791 - 920 square feet per Single-Family Residential Parcel		1,213.48	1,548.71	-
LM-01(N)	921 - 1,060 square feet per Single-Family Residential Parcel		1,405.08	1,793.25	-
LM-01(O)	1,061 - 1,210 square feet per Single-Family Residential Parcel		1,610.87	2,055.90	-
LM-01(P)	1,211 - 1,370 square feet per Single-Family Residential Parcel		1,830.86	2,336.68	-
LM-01(Q)	1,371 - 1,540 square feet per Single-Family Residential Parcel		2,065.04	2,635.55	-
LM-01(R)	1,541 - 1,720 square feet per Single-Family Residential Parcel		2,313.41	2,952.54	-
LM-01(S)	1,721 - 1,910 square feet per Single-Family Residential Parcel		2,575.98	3,287.65	-
LM-01(T)	1,911 - 2,110 square feet per Single-Family Residential Parcel		2,852.73	3,640.85	-
LM-02	Landscaping for Property Other than Single-Family Residential	per front linear			
LM-02A	Median(s) (other than Median(s)-Shared)		10.94	13.94	5.60
LM-02B	Median(s) Shared		5.47	6.96	1.55
LM-02C	Parkway(s)		13.48	17.17	-
SL-01	Single-Family Residential Street Lighting	per parcel	197.39	251.90	64.10
SL-02	Street Lighting for Property Other than Single-Family Residential	per front linear foot	3.25	4.12	1.21

The Maintenance Ratio represents the number of square feet of landscaping that will be maintained for each taxed parcel. The Maintenance Ratio is calculated by dividing the total landscaping for a given development by the number of parcels within that development. For example, if a development consists of 100 single family residential parcels, and the CFD will fund the maintenance of 15,000 square feet of landscaping in the subdivision, then the Maintenance Ratio for that development is 150 (15,000 divided by 100).

In accordance with the RMA, property classified as (i) Public Property, (ii) Property Owner Association Property, and (iii) property owned in common shall be identified as Tax-Exempt with regards to the special tax.

D. METHOD OF APPORTIONMENT

For each FY, the CFD Administrator shall determine the amount of the special tax to be levied and collected for each Tax Rate Area separately. The amount required shall include an amount necessary to pay for: (i) the Services funded by the CFD; (ii) Administrative Expenses; (iii) any amounts required to establish or replenish any Reserve Funds; and (iv) anticipated delinquent special taxes (not to exceed 10% of total requirement) less any surplus of funds available from the previous FY's special tax.

E. DELINQUENCIES

A history of the District's delinquencies since the first year the special tax was levied is summarized below.

Table 6: Delinquencies

FY	Amount Levied	Amount Delinquent*	Number of Delinquent Parcels	Percent Delinquent
2014/15	\$ 36,615.70	\$ -	-	0.00%
2015/16	27,546.60	-	-	0.00%
2016/17	24,658.78	-	-	0.00%
2017/18	118,159.02	-	-	0.00%
2018/19	209,656.96	12,476.63	274	5.95%

* Amount delinquent per the Riverside County Paid/Unpaid Reports dated February 19, 2019.

For FY 2018/19, of the \$104,828.48 due from 1st installment, \$12,476.63 was not paid. For all prior years there are no delinquencies.

V. SPECIAL TAX ALLOCATION (TAX ROLL)

The special tax for all applicable Tax Rate Areas shall be levied on all taxable property within the District. The following table identifies the parcels subject to the special tax, along with their total corresponding maximum special tax and applied special tax for FY 2019/20. The amounts listed in Table 7 may represent the special tax for more than one Tax Rate Area.

Table 7: Special Tax Allocation

**Community Facilities District No. 2014-01 (Maintenance Services)
Fiscal Year 2019/20 Special Tax Levy**

Assessor's Parcel Number	FY 2019/20 Total Maximum Special Tax	FY 2019/20 Total Applied Special Tax	Assessor's Parcel Number	FY 2019/20 Total Maximum Special Tax	FY 2019/20 Total Applied Special Tax	Assessor's Parcel Number	FY 2019/20 Total Maximum Special Tax	FY 2019/20 Total Applied Special Tax
259240062	251.90	64.10	488370028	849.62	421.12	487582012	1,365.88	252.04
259240090	251.90	64.10	488370030	849.62	421.12	487582013	1,365.88	252.04
259260029	351.50	163.70	488370031	849.62	421.12	487582014	1,365.88	252.04
259260036	351.50	163.70	488370032	849.62	421.12	487582015	1,365.88	252.04
259260039	351.50	163.70	488370033	849.62	421.12	487582016	1,365.88	252.04
259260041	351.50	163.70	488371001	849.62	421.12	487582017	1,365.88	252.04
259260042	351.50	163.70	488371002	849.62	421.12	487582018	1,365.88	252.04
259260082	351.50	163.70	488371003	849.62	421.12	487590001	1,365.88	252.04
259260084	351.50	163.70	488371004	849.62	421.12	487590002	1,365.88	252.04
259260086	351.50	163.70	488371005	849.62	421.12	487590003	1,365.88	252.04
291050075	4,223.00	1,240.24	488371006	849.62	421.12	487590004	1,365.88	252.04
291294024	633.36	141.04	488371007	849.62	421.12	487590005	1,365.88	252.04
291650023	-	-	488371008	849.62	421.12	487590006	1,365.88	252.04
291650024	-	-	488371009	849.62	421.12	487590007	1,365.88	252.04
291650025	-	-	488371010	849.62	421.12	487590008	1,365.88	252.04
291650026	-	-	488371011	849.62	421.12	487590009	1,365.88	252.04
291650027	-	-	488371012	849.62	421.12	487590010	1,365.88	252.04
291650028	-	-	488371013	849.62	421.12	487590011	1,365.88	252.04
292100018	1,675.77	492.14	488371014	849.62	421.12	487590012	1,365.88	252.04
292181001	383.19	112.52	488371015	849.62	421.12	487590013	1,365.88	252.04
292181002	386.71	113.56	488371016	849.62	421.12	487590014	1,365.88	252.04
292211001	140.62	41.28	488371017	849.62	421.12	487590015	1,365.88	252.04
297130052	2,158.97	867.30	488371018	849.62	421.12	487590016	1,365.88	252.04
297130053	2,145.56	861.92	488371019	849.62	421.12	487591001	1,365.88	252.04
297130054	4,157.03	1,669.96	488371020	849.62	421.12	487591002	1,365.88	252.04
297130065	3,449.09	768.10	488371021	849.62	421.12	487591003	1,365.88	252.04
312250058	1,933.84	517.96	488371022	849.62	421.12	487591004	1,365.88	252.04
312250059	3,248.31	870.04	474740001	251.90	64.10	487591005	1,365.88	252.04
316020049	365.88	146.98	474740002	251.90	64.10	487591006	1,365.88	252.04
316020050	11,318.54	4,546.80	474740003	251.90	64.10	487591007	1,365.88	252.04
316020051	2,789.24	1,120.50	474740004	251.90	64.10	487591008	1,365.88	252.04
316020052	1,406.50	565.02	474740005	251.90	64.10	487591009	1,365.88	252.04
316100055	1,932.40	567.52	474740006	251.90	64.10	487591010	1,365.88	252.04
316100057	1,129.54	331.72	474740007	251.90	64.10	487591011	1,365.88	252.04
316100058	16,660.71	4,893.06	474740008	251.90	64.10	487591012	1,365.88	252.04
316180015	7,762.08	2,279.64	474740009	251.90	64.10	487591013	1,365.88	252.04
316180016	-	-	474740010	251.90	64.10	487591014	1,365.88	252.04
316190012	4,063.51	1,193.40	474740011	251.90	64.10	487591015	1,365.88	252.04
316190049	381.81	112.12	474740012	251.90	64.10	487591016	1,365.88	252.04
316190052	5,386.80	1,419.00	474740013	251.90	64.10	487591017	1,365.88	252.04
316200036	7,628.59	2,240.42	474741001	251.90	64.10	487591018	1,365.88	252.04
316200042	6,904.32	1,887.08	474741002	251.90	64.10	487591019	1,365.88	252.04
316210016	481.24	141.32	474741003	251.90	64.10	487591020	1,365.88	252.04
316210017	481.24	141.32	474741004	251.90	64.10	487592001	1,365.88	252.04
316210018	1,923.17	564.80	474741005	251.90	64.10	487592002	1,365.88	252.04
316210036	5,203.49	1,849.68	474741006	251.90	64.10	487592003	1,365.88	252.04
316210037	5,203.49	1,849.68	474741007	251.90	64.10	487592004	1,365.88	252.04
316210038	5,192.67	1,845.84	474742001	251.90	64.10	487592005	1,365.88	252.04
316210092	8,911.13	2,617.10	474742002	251.90	64.10	487592006	1,365.88	252.04
316210094	4,102.29	1,204.78	474742003	251.90	64.10	487592007	1,365.88	252.04
316210097	2,729.50	801.62	474742004	251.90	64.10	487592008	1,365.88	252.04
475150044	251.90	64.10	474742005	251.90	64.10	487592009	1,365.88	252.04
475150045	251.90	64.10	474742006	251.90	64.10	488410001	251.90	64.10
475150046	251.90	64.10	474742007	251.90	64.10	488410002	251.90	64.10
475150047	251.90	64.10	474742008	251.90	64.10	488410003	251.90	64.10
475150048	251.90	64.10	474742009	251.90	64.10	488410004	251.90	64.10
475150049	251.90	64.10	474742010	251.90	64.10	488410005	251.90	64.10
475150050	251.90	64.10	474742011	251.90	64.10	488410006	251.90	64.10
475150051	251.90	64.10	474742012	251.90	64.10	488410007	251.90	64.10
475150052	251.90	64.10	474742013	251.90	64.10	488410008	251.90	64.10
475150053	251.90	64.10	474742014	251.90	64.10	488410009	251.90	64.10
475150054	251.90	64.10	474742015	251.90	64.10	488410010	251.90	64.10
475150055	251.90	64.10	474742016	251.90	64.10	488410011	251.90	64.10
475150056	251.90	64.10	474742017	251.90	64.10	488410012	251.90	64.10
475150057	251.90	64.10	474742018	251.90	64.10	488410013	251.90	64.10
475150058	251.90	64.10	474742019	251.90	64.10	488410014	251.90	64.10
475150059	251.90	64.10	474742020	251.90	64.10	488410015	251.90	64.10
475220060	251.90	64.10	474742021	251.90	64.10	488410016	251.90	64.10

**Community Facilities District No. 2014-01 (Maintenance Services)
Fiscal Year 2019/20 Special Tax Levy**

Assessor's Parcel Number	FY 2019/20 Total Maximum Special Tax	FY 2019/20 Total Applied Special Tax	Assessor's Parcel Number	FY 2019/20 Total Maximum Special Tax	FY 2019/20 Total Applied Special Tax	Assessor's Parcel Number	FY 2019/20 Total Maximum Special Tax	FY 2019/20 Total Applied Special Tax
475220061	251.90	64.10	474750001	251.90	64.10	488410017	251.90	64.10
475220062	251.90	64.10	474750002	251.90	64.10	488410018	251.90	64.10
475220063	251.90	64.10	474750003	251.90	64.10	488410019	251.90	64.10
478441015	1,003.61	127.84	474750004	251.90	64.10	488410020	251.90	64.10
478441016	1,003.61	127.84	474750005	251.90	64.10	488410021	251.90	64.10
478441017	1,003.61	127.84	474750006	251.90	64.10	488410022	251.90	64.10
478441018	1,003.61	127.84	474750007	251.90	64.10	488410023	251.90	64.10
478441019	1,003.61	127.84	474750008	251.90	64.10	488410024	251.90	64.10
478441020	1,003.61	127.84	474750009	251.90	64.10	488410025	251.90	64.10
478441021	1,003.61	127.84	474750010	251.90	64.10	488410026	251.90	64.10
479040039	1,145.36	336.38	474750011	251.90	64.10	488410027	251.90	64.10
481250045	251.90	64.10	474750012	251.90	64.10	488410028	251.90	64.10
481250046	251.90	64.10	474750013	251.90	64.10	488410029	251.90	64.10
481250047	251.90	64.10	474750014	251.90	64.10	488410030	251.90	64.10
481250048	251.90	64.10	474750015	251.90	64.10	488410031	251.90	64.10
481250049	251.90	64.10	474750016	251.90	64.10	488410032	251.90	64.10
481250050	251.90	64.10	474750017	251.90	64.10	488410033	251.90	64.10
481250051	251.90	64.10	474750018	251.90	64.10	488410034	251.90	64.10
481250052	251.90	64.10	474750019	251.90	64.10	488410035	251.90	64.10
485081037	251.47	73.84	474750020	251.90	64.10	488410036	251.90	64.10
485081043	788.50	231.56	474751001	251.90	64.10	488410037	251.90	64.10
485111001	713.78	126.76	474751002	251.90	64.10	488410038	251.90	64.10
485111002	713.78	126.76	474751003	251.90	64.10	488410039	251.90	64.10
485111003	713.78	126.76	474751004	251.90	64.10	488410040	251.90	64.10
485111004	713.78	126.76	474751005	251.90	64.10	488410041	251.90	64.10
485111005	713.78	126.76	474751006	251.90	64.10	488410042	251.90	64.10
485111006	713.78	126.76	474751007	251.90	64.10	488410043	251.90	64.10
485111007	713.78	126.76	474751008	251.90	64.10	488410044	251.90	64.10
485111008	713.78	126.76	474751009	251.90	64.10	488410045	251.90	64.10
485111009	713.78	126.76	474751010	251.90	64.10	488410046	251.90	64.10
485111010	713.78	126.76	474751011	251.90	64.10	488410047	251.90	64.10
485111011	713.78	126.76	474751012	251.90	64.10	488410048	251.90	64.10
485111012	713.78	126.76	474751013	251.90	64.10	488410049	251.90	64.10
485111013	713.78	126.76	474751014	251.90	64.10	488410050	251.90	64.10
485111014	713.78	126.76	474751015	251.90	64.10	488410051	251.90	64.10
485111015	713.78	126.76	474751016	251.90	64.10	488410052	251.90	64.10
485111016	713.78	126.76	474751017	251.90	64.10	488410053	251.90	64.10
485111017	713.78	126.76	474751018	251.90	64.10	488410054	251.90	64.10
485111018	713.78	126.76	474751019	251.90	64.10	488410055	251.90	64.10
485112001	713.78	126.76	474751020	251.90	64.10	488410056	251.90	64.10
485112002	713.78	126.76	474760001	251.90	64.10	488410057	251.90	64.10
485112003	713.78	126.76	474760002	251.90	64.10	488410058	251.90	64.10
485112004	713.78	126.76	474760003	251.90	64.10	488410059	251.90	64.10
485112005	713.78	126.76	474760004	251.90	64.10	488420001	251.90	64.10
485112006	713.78	126.76	474760005	251.90	64.10	488420002	251.90	64.10
485112007	713.78	126.76	474760006	251.90	64.10	488420003	251.90	64.10
485112008	713.78	126.76	474760007	251.90	64.10	488420004	251.90	64.10
485112022	713.78	126.76	474760008	251.90	64.10	488420005	251.90	64.10
485112023	713.78	126.76	474760009	251.90	64.10	488420006	251.90	64.10
485113003	713.78	126.76	474760010	251.90	64.10	488420007	251.90	64.10
485113004	713.78	126.76	474760011	251.90	64.10	488420008	251.90	64.10
485113005	713.78	126.76	474760012	251.90	64.10	488420009	251.90	64.10
485113006	713.78	126.76	474760013	251.90	64.10	488420010	251.90	64.10
485113007	713.78	126.76	474760014	251.90	64.10	488420011	251.90	64.10
485113008	713.78	126.76	474760015	251.90	64.10	488420012	251.90	64.10
485113009	713.78	126.76	474760016	251.90	64.10	488420013	251.90	64.10
485113010	713.78	126.76	474760017	251.90	64.10	488420014	251.90	64.10
485113011	713.78	126.76	474760018	251.90	64.10	488420015	251.90	64.10
485113012	713.78	126.76	474760019	251.90	64.10	488420016	251.90	64.10
485113013	713.78	126.76	474760020	251.90	64.10	488420017	251.90	64.10
485113014	713.78	126.76	474760021	251.90	64.10	488420018	251.90	64.10
485113015	713.78	126.76	474761001	251.90	64.10	488420019	251.90	64.10
485113016	713.78	126.76	474761002	251.90	64.10	488420020	251.90	64.10
485113017	713.78	126.76	474761003	251.90	64.10	488420021	251.90	64.10
485113018	713.78	126.76	474761004	251.90	64.10	488420022	251.90	64.10
485113019	713.78	126.76	474761005	251.90	64.10	488420023	251.90	64.10
485113020	713.78	126.76	474761006	251.90	64.10	488420024	251.90	64.10
485113021	713.78	126.76	474761007	251.90	64.10	488420025	251.90	64.10
485113022	713.78	126.76	474761008	251.90	64.10	488420026	251.90	64.10

**Community Facilities District No. 2014-01 (Maintenance Services)
Fiscal Year 2019/20 Special Tax Levy**

Assessor's Parcel Number	FY 2019/20 Total Maximum Special Tax	FY 2019/20 Total Applied Special Tax	Assessor's Parcel Number	FY 2019/20 Total Maximum Special Tax	FY 2019/20 Total Applied Special Tax	Assessor's Parcel Number	FY 2019/20 Total Maximum Special Tax	FY 2019/20 Total Applied Special Tax
485113023	713.78	126.76	474761009	251.90	64.10	488420027	251.90	64.10
485113024	713.78	126.76	474761010	251.90	64.10	488420028	251.90	64.10
485113025	713.78	126.76	474761011	251.90	64.10	488420029	251.90	64.10
485113026	713.78	126.76	474761012	251.90	64.10	488420030	251.90	64.10
485113027	713.78	126.76	478440001	1,003.61	127.84	488420031	251.90	64.10
485113028	713.78	126.76	478440002	1,003.61	127.84	488420032	251.90	64.10
485113029	713.78	126.76	478440003	1,003.61	127.84	488420033	251.90	64.10
485113033	713.78	126.76	478440004	1,003.61	127.84	488420034	251.90	64.10
485114001	713.78	126.76	478440005	1,003.61	127.84	488420035	251.90	64.10
485114002	713.78	126.76	478440006	1,003.61	127.84	488420036	251.90	64.10
485114003	713.78	126.76	478440007	1,003.61	127.84	488420037	251.90	64.10
485114004	713.78	126.76	478440008	1,003.61	127.84	488420038	251.90	64.10
485114005	713.78	126.76	478440009	1,003.61	127.84	488420039	251.90	64.10
485114006	713.78	126.76	478440010	1,003.61	127.84	488420040	251.90	64.10
485114007	713.78	126.76	478440011	1,003.61	127.84	488420041	251.90	64.10
485114008	713.78	126.76	478440012	1,003.61	127.84	488420042	251.90	64.10
485114009	713.78	126.76	478440013	1,003.61	127.84	488420043	251.90	64.10
485114010	713.78	126.76	478440014	1,003.61	127.84	488430003	251.90	64.10
485114011	713.78	126.76	478440015	1,003.61	127.84	488430004	251.90	64.10
485114012	713.78	126.76	478440016	1,003.61	127.84	488430005	251.90	64.10
485114013	713.78	126.76	478440017	1,003.61	127.84	488430006	251.90	64.10
485114014	713.78	126.76	478440018	1,003.61	127.84	488430007	251.90	64.10
485114015	713.78	126.76	478440019	1,003.61	127.84	488430008	251.90	64.10
485114016	713.78	126.76	478440020	1,003.61	127.84	488430009	251.90	64.10
485114017	713.78	126.76	478440021	1,003.61	127.84	488430010	251.90	64.10
485114018	713.78	126.76	478440022	1,003.61	127.84	488430011	251.90	64.10
485114019	713.78	126.76	478440023	1,003.61	127.84	488430012	251.90	64.10
485114020	713.78	126.76	478440024	1,003.61	127.84	488430013	251.90	64.10
485114021	713.78	126.76	478440025	1,003.61	127.84	488430014	251.90	64.10
485114022	713.78	126.76	478440026	1,003.61	127.84	488430015	251.90	64.10
485121001	713.78	126.76	478440027	1,003.61	127.84	488430016	251.90	64.10
485121002	713.78	126.76	478440028	1,003.61	127.84	488430017	251.90	64.10
485121003	713.78	126.76	478440029	1,003.61	127.84	488430018	251.90	64.10
485121004	713.78	126.76	478440030	1,003.61	127.84	488430019	251.90	64.10
485121005	713.78	126.76	478440031	1,003.61	127.84	488430020	251.90	64.10
485121006	713.78	126.76	478440032	1,003.61	127.84	488430021	251.90	64.10
485121007	713.78	126.76	478440033	1,003.61	127.84	488430022	251.90	64.10
485121008	713.78	126.76	478440034	1,003.61	127.84	488430023	251.90	64.10
485121009	713.78	126.76	478440035	1,003.61	127.84	488430024	251.90	64.10
485121010	713.78	126.76	478440036	1,003.61	127.84	488430025	251.90	64.10
485121014	713.78	126.76	478440037	1,003.61	127.84	488430026	251.90	64.10
485121015	713.78	126.76	478440038	1,003.61	127.84	488430027	251.90	64.10
485121016	713.78	126.76	478440039	1,003.61	127.84	488430028	251.90	64.10
485121017	713.78	126.76	478440040	1,003.61	127.84	488430029	251.90	64.10
485121018	713.78	126.76	478440041	1,003.61	127.84	488430030	251.90	64.10
485121019	713.78	126.76	478440042	1,003.61	127.84	488430031	251.90	64.10
485121020	713.78	126.76	478440043	1,003.61	127.84	488430032	251.90	64.10
485121021	713.78	126.76	478440044	1,003.61	127.84	488430033	251.90	64.10
485121025	713.78	126.76	478440045	1,003.61	127.84	488430034	251.90	64.10
485122001	713.78	126.76	478440046	1,003.61	127.84	488430035	251.90	64.10
485122002	713.78	126.76	478450001	1,003.61	127.84	488430036	251.90	64.10
485122003	713.78	126.76	478450002	1,003.61	127.84	488430037	251.90	64.10
485122004	713.78	126.76	478450003	1,003.61	127.84	488430038	251.90	64.10
485122005	713.78	126.76	478450004	1,003.61	127.84	488430039	251.90	64.10
485122006	713.78	126.76	478450005	1,003.61	127.84	488430040	251.90	64.10
485122007	713.78	126.76	478450006	1,003.61	127.84	488430041	251.90	64.10
485122008	713.78	126.76	478450007	1,003.61	127.84	488430042	251.90	64.10
485122009	713.78	126.76	478450008	1,003.61	127.84	488430043	251.90	64.10
485122010	713.78	126.76	478450009	1,003.61	127.84	488430044	251.90	64.10
485122011	713.78	126.76	478450010	1,003.61	127.84	488430045	251.90	64.10
485122012	713.78	126.76	478450011	1,003.61	127.84	488430046	251.90	64.10
485123001	713.78	126.76	478450012	1,003.61	127.84	488430047	251.90	64.10
485123002	713.78	126.76	478450013	1,003.61	127.84	488430048	251.90	64.10
485123003	713.78	126.76	478450014	1,003.61	127.84	488430049	251.90	64.10
485123004	713.78	126.76	478450015	1,003.61	127.84	488430050	251.90	64.10
485123005	713.78	126.76	478450016	1,003.61	127.84	488430051	251.90	64.10
485123006	713.78	126.76	478450017	1,003.61	127.84	488430052	251.90	64.10
485123007	713.78	126.76	478450018	1,003.61	127.84	488430053	251.90	64.10
485123008	713.78	126.76	478450019	1,003.61	127.84	488430054	251.90	64.10

**Community Facilities District No. 2014-01 (Maintenance Services)
Fiscal Year 2019/20 Special Tax Levy**

Assessor's Parcel Number	FY 2019/20 Total Maximum Special Tax	FY 2019/20 Total Applied Special Tax	Assessor's Parcel Number	FY 2019/20 Total Maximum Special Tax	FY 2019/20 Total Applied Special Tax	Assessor's Parcel Number	FY 2019/20 Total Maximum Special Tax	FY 2019/20 Total Applied Special Tax
485123009	713.78	126.76	478450020	1,003.61	127.84	488430055	251.90	64.10
485123010	713.78	126.76	478450021	1,003.61	127.84	488430056	251.90	64.10
485123011	713.78	126.76	478450022	1,003.61	127.84	488430057	251.90	64.10
485123012	713.78	126.76	478450023	1,003.61	127.84	488430058	251.90	64.10
485123013	713.78	126.76	478450024	1,003.61	127.84	488430059	251.90	64.10
485123014	713.78	126.76	478450025	1,003.61	127.84	488430060	251.90	64.10
485123015	713.78	126.76	478450026	1,003.61	127.84	488430061	251.90	64.10
485123016	713.78	126.76	478450027	1,003.61	127.84	488440001	251.90	64.10
485123017	713.78	126.76	478450028	1,003.61	127.84	488440002	251.90	64.10
485123018	713.78	126.76	478450029	1,003.61	127.84	488440003	251.90	64.10
485123019	713.78	126.76	478450030	1,003.61	127.84	488440004	251.90	64.10
485123020	713.78	126.76	478450031	1,003.61	127.84	488440005	251.90	64.10
485123021	713.78	126.76	478450032	1,003.61	127.84	488440006	251.90	64.10
485123022	713.78	126.76	478451001	1,003.61	127.84	488440007	251.90	64.10
485123023	713.78	126.76	478451002	1,003.61	127.84	488440008	251.90	64.10
485123024	713.78	126.76	478451003	1,003.61	127.84	488440009	251.90	64.10
485123025	713.78	126.76	478451004	1,003.61	127.84	488440010	251.90	64.10
485123026	713.78	126.76	478451005	1,003.61	127.84	488440011	251.90	64.10
485123027	713.78	126.76	478451006	1,003.61	127.84	488440012	251.90	64.10
485123028	713.78	126.76	478451007	1,003.61	127.84	488440013	251.90	64.10
485123029	713.78	126.76	478451008	1,003.61	127.84	488440014	251.90	64.10
485123030	713.78	126.76	478451009	1,003.61	127.84	488440015	251.90	64.10
485123031	713.78	126.76	478452001	1,003.61	127.84	488440016	251.90	64.10
485230036	15,396.86	6,185.24	478452002	1,003.61	127.84	488440017	251.90	64.10
486542013	251.90	64.10	478452003	1,003.61	127.84	488440018	251.90	64.10
486542014	251.90	64.10	478452004	1,003.61	127.84	488440019	251.90	64.10
486542015	251.90	64.10	478452005	1,003.61	127.84	488440020	251.90	64.10
486542016	251.90	64.10	478452006	1,003.61	127.84	488440021	251.90	64.10
486542017	251.90	64.10	478452007	1,003.61	127.84	488440022	251.90	64.10
486542018	251.90	64.10	478452008	1,003.61	127.84	488440023	251.90	64.10
486542019	251.90	64.10	478452009	1,003.61	127.84	488440024	251.90	64.10
486542020	251.90	64.10	478452010	1,003.61	127.84	488440025	251.90	64.10
486542021	251.90	64.10	478452011	1,003.61	127.84	488440026	251.90	64.10
486542022	251.90	64.10	478452012	1,003.61	127.84	488440027	251.90	64.10
486542023	251.90	64.10	478452013	1,003.61	127.84	488440028	251.90	64.10
486542024	251.90	64.10	478452014	1,003.61	127.84	488440029	251.90	64.10
486542025	251.90	64.10	478452015	1,003.61	127.84	488440030	251.90	64.10
486542026	251.90	64.10	478452016	1,003.61	127.84	488440031	251.90	64.10
486542027	251.90	64.10	478452017	1,003.61	127.84	488440032	251.90	64.10
486542028	251.90	64.10	478452018	1,003.61	127.84	488440033	251.90	64.10
486542029	251.90	64.10	478452019	1,003.61	127.84	488440034	251.90	64.10
486542030	251.90	64.10	478452020	1,003.61	127.84	488440035	251.90	64.10
486542031	251.90	64.10	478452021	1,003.61	127.84	488440036	251.90	64.10
486542032	251.90	64.10	478460001	1,003.61	127.84	488440037	251.90	64.10
486542033	251.90	64.10	478460002	1,003.61	127.84	488440038	251.90	64.10
486542034	251.90	64.10	478460003	1,003.61	127.84	488440039	251.90	64.10
486542035	251.90	64.10	478460004	1,003.61	127.84	488440040	251.90	64.10
486542036	251.90	64.10	478460005	1,003.61	127.84	488440041	251.90	64.10
486542037	251.90	64.10	478460006	1,003.61	127.84	488440042	251.90	64.10
486542038	251.90	64.10	478460007	1,003.61	127.84	488440043	251.90	64.10
486542039	251.90	64.10	478461001	1,003.61	127.84	488440044	251.90	64.10
486542040	251.90	64.10	478461002	1,003.61	127.84	488440045	251.90	64.10
486543001	251.90	64.10	478461003	1,003.61	127.84	488440046	251.90	64.10
486543002	251.90	64.10	478461004	1,003.61	127.84	488440047	251.90	64.10
486543003	251.90	64.10	478461005	1,003.61	127.84	488440048	251.90	64.10
486543004	251.90	64.10	478461006	1,003.61	127.84	488440049	251.90	64.10
486543005	251.90	64.10	478461007	1,003.61	127.84	488440050	251.90	64.10
486543006	251.90	64.10	478461008	1,003.61	127.84	488440051	251.90	64.10
486543007	251.90	64.10	478461009	1,003.61	127.84	488440052	251.90	64.10
486543008	251.90	64.10	478461010	1,003.61	127.84	488440053	251.90	64.10
486543009	251.90	64.10	478461011	1,003.61	127.84	488440054	251.90	64.10
486543010	251.90	64.10	478461012	1,003.61	127.84	488440055	251.90	64.10
486543011	251.90	64.10	478461013	1,003.61	127.84	488440056	251.90	64.10
486543012	251.90	64.10	478461014	1,003.61	127.84	488440057	251.90	64.10
487540001	251.90	64.10	478461015	1,003.61	127.84	488440058	251.90	64.10
487540002	251.90	64.10	478461016	1,003.61	127.84	488440059	251.90	64.10
487540003	251.90	64.10	478461017	1,003.61	127.84	488440060	251.90	64.10
487540004	251.90	64.10	478461018	1,003.61	127.84	488440061	251.90	64.10
487540005	251.90	64.10	478461019	1,003.61	127.84	488440062	251.90	64.10

**Community Facilities District No. 2014-01 (Maintenance Services)
Fiscal Year 2019/20 Special Tax Levy**

Assessor's Parcel Number	FY 2019/20 Total Maximum Special Tax	FY 2019/20 Total Applied Special Tax	Assessor's Parcel Number	FY 2019/20 Total Maximum Special Tax	FY 2019/20 Total Applied Special Tax	Assessor's Parcel Number	FY 2019/20 Total Maximum Special Tax	FY 2019/20 Total Applied Special Tax
487540006	251.90	64.10	478461020	1,003.61	127.84	488440063	251.90	64.10
487540007	251.90	64.10	478461021	1,003.61	127.84	488440064	251.90	64.10
487540008	251.90	64.10	478461022	1,003.61	127.84	488440065	251.90	64.10
487540009	251.90	64.10	478461023	1,003.61	127.84	488440066	251.90	64.10
487540010	251.90	64.10	478462001	1,003.61	127.84	488440067	251.90	64.10
487540011	251.90	64.10	478462002	1,003.61	127.84	488450001	251.90	64.10
487540012	251.90	64.10	478462003	1,003.61	127.84	488450002	251.90	64.10
487540013	251.90	64.10	478462004	1,003.61	127.84	488450003	251.90	64.10
487540014	251.90	64.10	478462005	1,003.61	127.84	488450004	251.90	64.10
487540015	251.90	64.10	478462006	1,003.61	127.84	488450005	251.90	64.10
487540016	251.90	64.10	478462007	1,003.61	127.84	488450006	251.90	64.10
487541001	251.90	64.10	478462008	1,003.61	127.84	488450007	251.90	64.10
487541002	251.90	64.10	478462009	1,003.61	127.84	488450008	251.90	64.10
487541003	251.90	64.10	478462010	1,003.61	127.84	488450009	251.90	64.10
487541004	251.90	64.10	478462011	1,003.61	127.84	488450010	251.90	64.10
487541005	251.90	64.10	478462012	1,003.61	127.84	488450011	251.90	64.10
487541006	251.90	64.10	478462013	1,003.61	127.84	488450012	251.90	64.10
487541007	251.90	64.10	478462014	1,003.61	127.84	488450013	251.90	64.10
487541008	251.90	64.10	487580001	1,365.88	252.04	488450014	251.90	64.10
488330043	2,049.06	601.78	487580002	1,365.88	252.04	488450015	251.90	64.10
488330044	8,349.70	2,452.20	487580003	1,365.88	252.04	488450016	251.90	64.10
488330045	183.91	54.00	487580004	1,365.88	252.04	488450017	251.90	64.10
488330046	3,399.97	998.52	487580005	1,365.88	252.04	488450018	251.90	64.10
488330047	8,207.04	2,410.32	487580006	1,365.88	252.04	488450019	251.90	64.10
488370001	849.62	421.12	487580007	1,365.88	252.04	488450020	251.90	64.10
488370002	849.62	421.12	487580008	1,365.88	252.04	488450021	251.90	64.10
488370003	849.62	421.12	487580009	1,365.88	252.04	488450022	251.90	64.10
488370004	849.62	421.12	487580010	1,365.88	252.04	488450023	251.90	64.10
488370005	849.62	421.12	487580011	1,365.88	252.04	488450024	251.90	64.10
488370006	849.62	421.12	487580012	1,365.88	252.04	488450025	251.90	64.10
488370007	849.62	421.12	487580013	1,365.88	252.04	488450026	251.90	64.10
488370008	849.62	421.12	487580014	1,365.88	252.04	488450027	251.90	64.10
488370009	849.62	421.12	487580015	1,365.88	252.04	488450028	251.90	64.10
488370010	849.62	421.12	487580016	1,365.88	252.04	488450029	251.90	64.10
488370011	849.62	421.12	487581001	1,365.88	252.04	488450030	251.90	64.10
488370012	849.62	421.12	487581002	1,365.88	252.04	488450031	251.90	64.10
488370013	849.62	421.12	487581003	1,365.88	252.04	488450032	251.90	64.10
488370014	849.62	421.12	487581004	1,365.88	252.04	488450033	251.90	64.10
488370015	849.62	421.12	487581005	1,365.88	252.04	488450034	251.90	64.10
488370016	849.62	421.12	487581006	1,365.88	252.04	488450035	251.90	64.10
488370017	849.62	421.12	487581007	1,365.88	252.04	488450036	251.90	64.10
488370018	849.62	421.12	487582001	1,365.88	252.04	488450037	251.90	64.10
488370019	849.62	421.12	487582002	1,365.88	252.04	488450038	251.90	64.10
488370020	849.62	421.12	487582003	1,365.88	252.04	488450039	251.90	64.10
488370021	849.62	421.12	487582004	1,365.88	252.04	488450040	251.90	64.10
488370022	849.62	421.12	487582005	1,365.88	252.04	488450041	251.90	64.10
488370023	849.62	421.12	487582006	1,365.88	252.04	488450042	251.90	64.10
488370024	849.62	421.12	487582007	1,365.88	252.04	488450043	251.90	64.10
488370025	849.62	421.12	487582008	1,365.88	252.04	488450044	251.90	64.10
488370026	849.62	421.12	487582009	1,365.88	252.04	488450045	251.90	64.10
488370027	849.62	421.12	487582010	1,365.88	252.04	488450046	251.90	64.10
488370028	849.62	421.12	487582011	1,365.88	252.04			
Subtotal 1	\$ 91,127.04		Subtotal 2	\$ 46,678.68		Subtotal 3	\$ 30,669.48	
Special Tax Levy								
Subtotal 1	\$ 91,127.04							
Subtotal 2	46,678.68							
Subtotal 3	30,669.48							
Total Special Tax Levy	\$ 168,475.20							
¹ After the property owner annexed into the district it was determined there would be no landscape improvements installed adjacent to the project.								
² CFD No. 2014-01 improvements are only installed adjacent to APN 316-180-015 so the Maximum and Applied Special Tax was not allocated to 316-180-016.								

Appendix A: Annexations

Table 8: Annexations

FY	Annexation Number	Tract No./Development	Number of Parcels ¹	Resolution No.	Date of Annexation	Tax Rate Areas & Maintenance Categories
2014/15	1	36598	8	2014-97	December 9, 2014	SL-01
2014/15	2	31789	24	2015-09	February 10, 2015	SL-01
2014/15	3	CSIP WR Moreno Valley	4	2015-18	March 24, 2015	LM-02A
2014/15	4	36436	159	2015-18	March 24, 2015	SL-01 & LM-01 (I)
2014/15	5	RB Johnson Investments, LLC	1	2015-18	March 24, 2015	SL-02
2015/16	6	Les Schwab Tires	1	2015-77	December 1, 2015	SL-02
2015/16	7	FR CAL Moreno Valley	2	2015-69	October 27, 2015	SL-02
2015/16	8	31592	114	2016-65	October 13, 2015	SL-01
2015/16	9	First Industrial	1	2016-03	February 2, 2016	SL-02 & LM-02B
2015/16	10	36882	40	2016-16	April 5, 2016	SL-01
2015/16	11	35606	16	2016-24	May 3, 2016	SL-01
2016/17	12	Riverview Partners	1	2017-22	April 18, 2017	SL-02
2017/18	13	Prologis	5	2018-03	January 16, 2018	SL-02
2016/17	14	TTM 29343	2	2016-70	October 18, 2016	SL-01
2016/17	15	Luis Valenzuela	1	2016-66	September 20, 2016	LM-02B
2016/17	16	Duke Realty	1	2016-63	August 16, 2016	LM-02A
2016/17	17	RSI Tract 22180	140	2016-78	December 12, 2016	SL-01 & LM-01(G) ²
2016/17	18	Tract 36933	274 ³	2017-27	May 16, 2017	SL-01
2016/17	19	Kearny Modular Way, LLC	2	2016-70	October 18, 2016	SL-02 & LM-02B
2016/17	20	First Industrial	5	2016-78	December 12, 2016	SL-02
2016/17	21	Corona South Main Development	6	2017-15	March 21, 2017	LM-02A
2016/17	22	Tract 31305	86	2017-24	May 2, 2017	SL-01 & LM-01(K) ⁴
2017/18	23	Supreme Truck	1	2017-45	August 15, 2017	LM-02B
2017/18	24	OM MacArthur	3	2017-53	October 17, 2017	SL-02
2017/18	25	Indian Commerce Center	1	2017-57	November 7, 2017	SL-02
2017/18	26	Duke Realty Limited Partnership	1	2017-63	December 5, 2017	SL-02 & LM-02B
2017/18	27	Cactus Commerce Center	3	2018-28	May 1, 2018	LM-02A
2017/18	28	TTM 31621	4	2018-29	May 1, 2018	SL-01
2018/19	29	Amazon Overflow Parking	1	2018-67	August 21, 2018	SL-02
2018/19	30	Rivard Truck Parking	2	2018-79	October 16, 2018	SL-02
2018/19	31	Duke Realty Nandina Ind. Facility	3	2019-01	January 15, 2019	SL-02 & LM-02A
2018/19	32	KB Home Coastal Inc	8	2019-11	March 19, 2019	SL-01 & LM-01(C)
2018/19	33	Prologis, L.P.	3	2019-04	February 19, 2019	SL-02
2018/19	34	Arlene Hamann, et al	2	2019-12	March 19, 2019	SL-02
Total Annexed Parcels			925			
Original District Boundaries Parcels			31618			SL-01 & LM-01(H)
Total Parcels			980			

¹ Parcel counts may be updated from time to time due to the recordation of parcel or tract maps.

² Landscape square footages were updated after plan check was completed. This development was re-categorized to Maintenance Category G starting FY 2019/20.

³ Annexed 8 parent parcels into District. Actual parcel count for FY 2017/18 is 72, which includes former condo parcels. Recordation of TTM 36933 created 274 residential lots.

⁴ Landscape plans were submitted after the rates were calculated for FY 2017/18. This development was re-categorized to Maintenance Category K in FY 2018/19.

Appendix B: District Maps

Map 1: CFD No. 2014-01 District Boundary

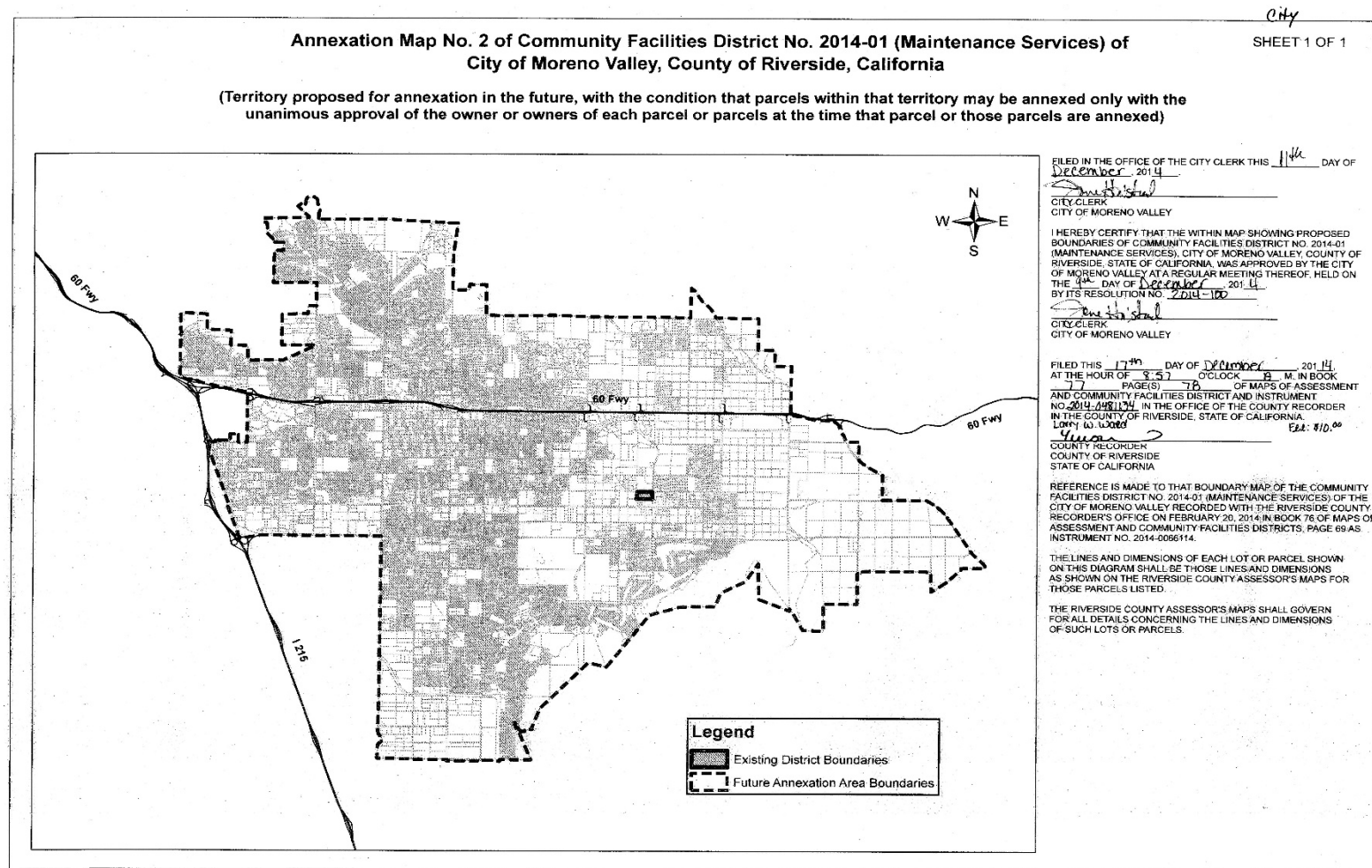

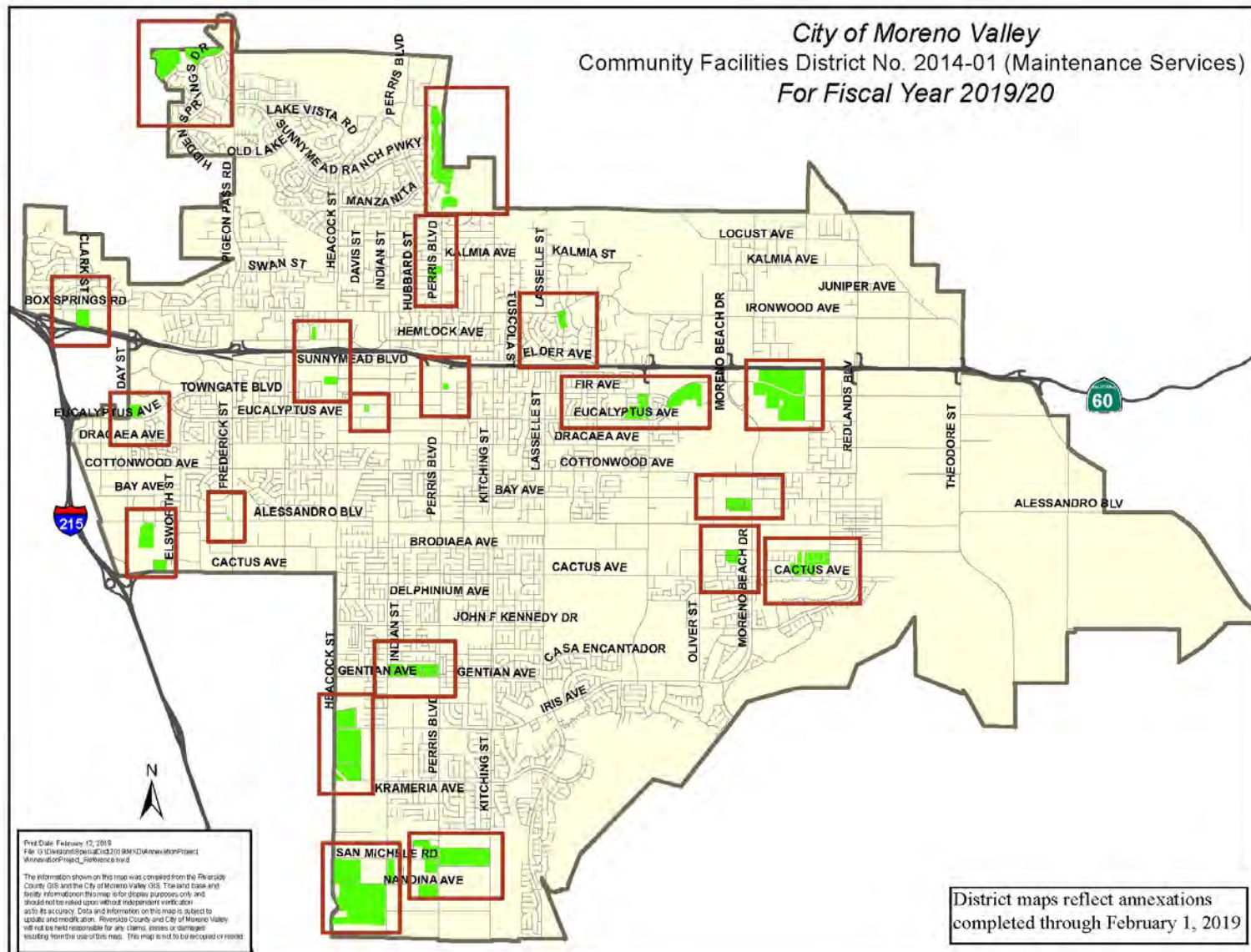

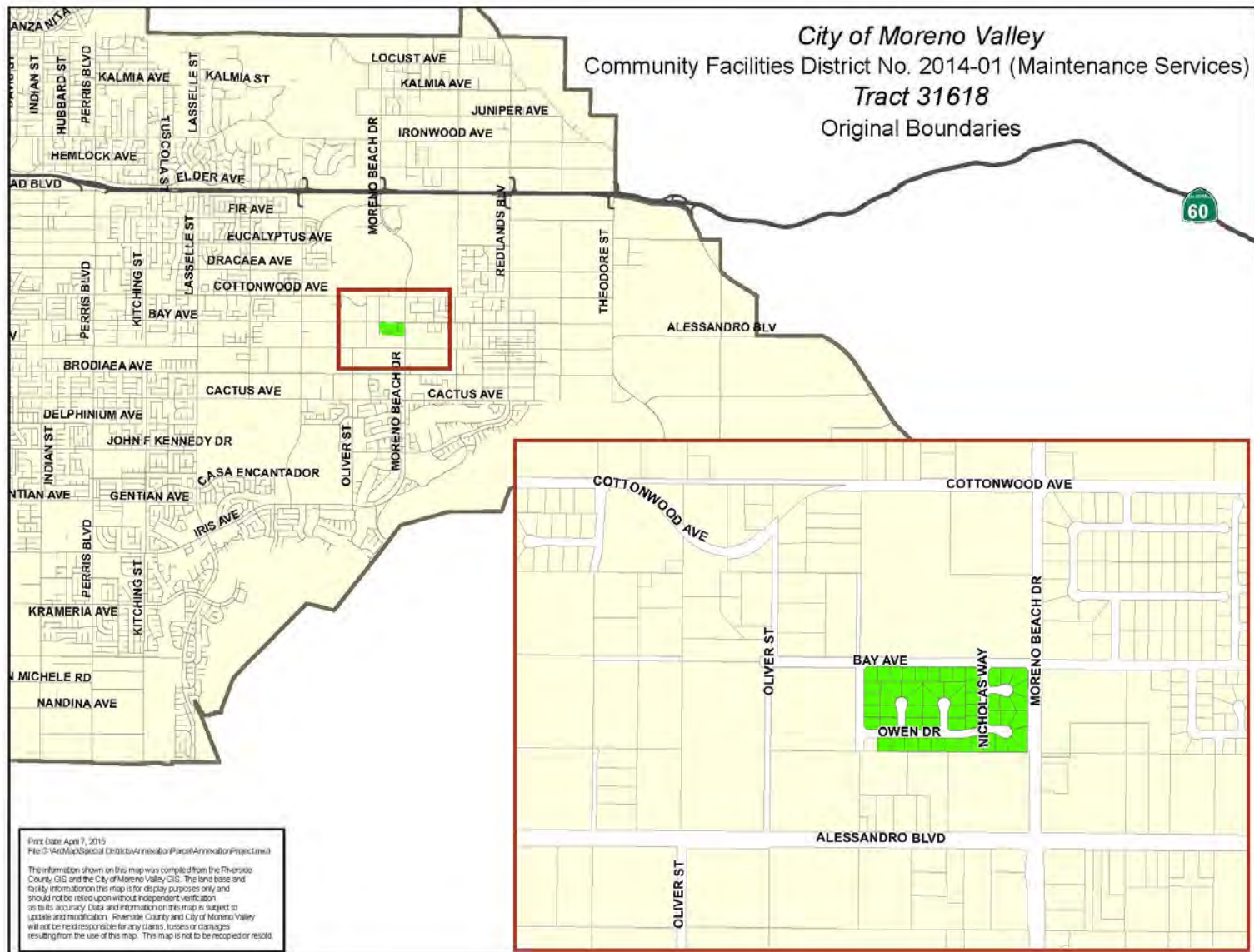

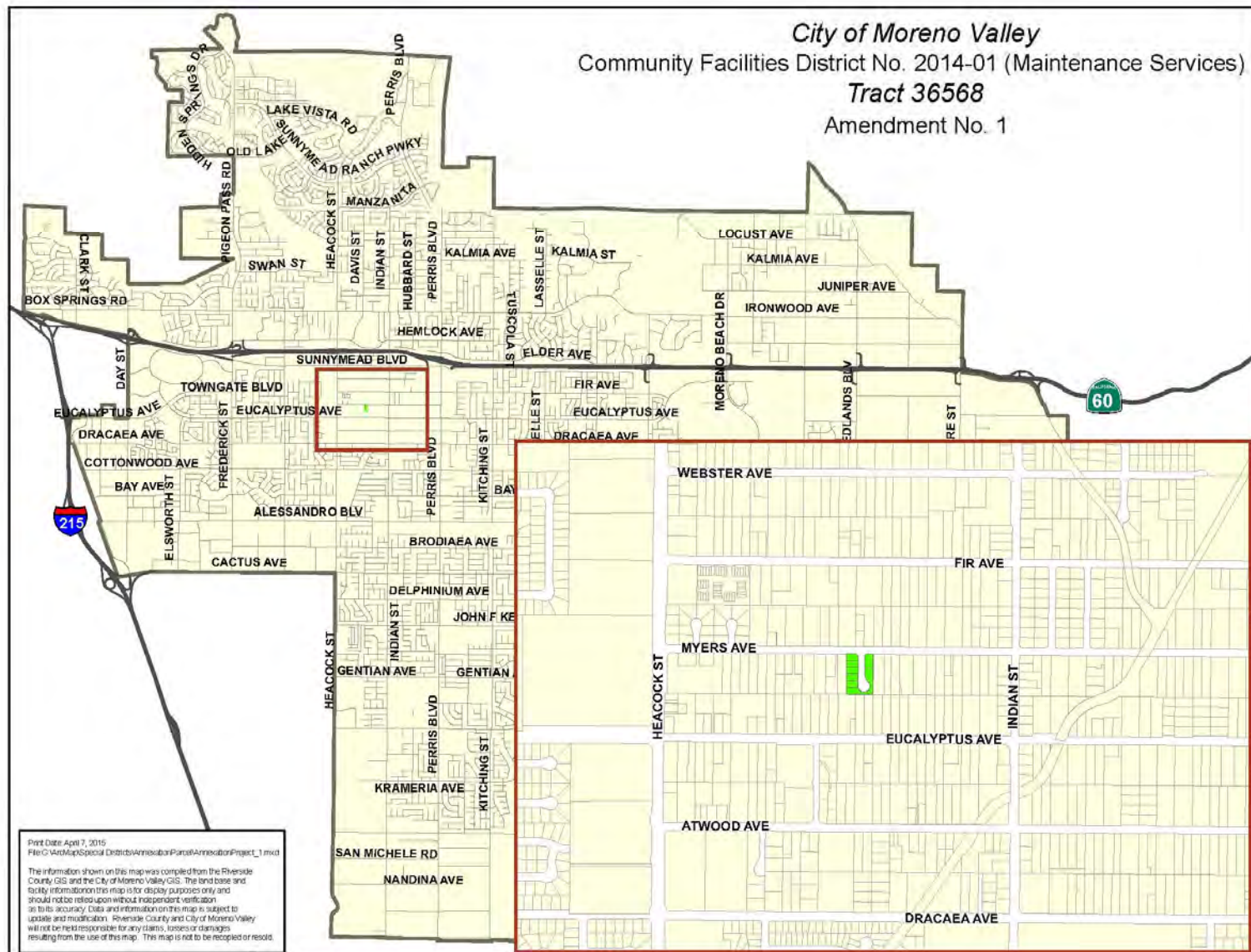

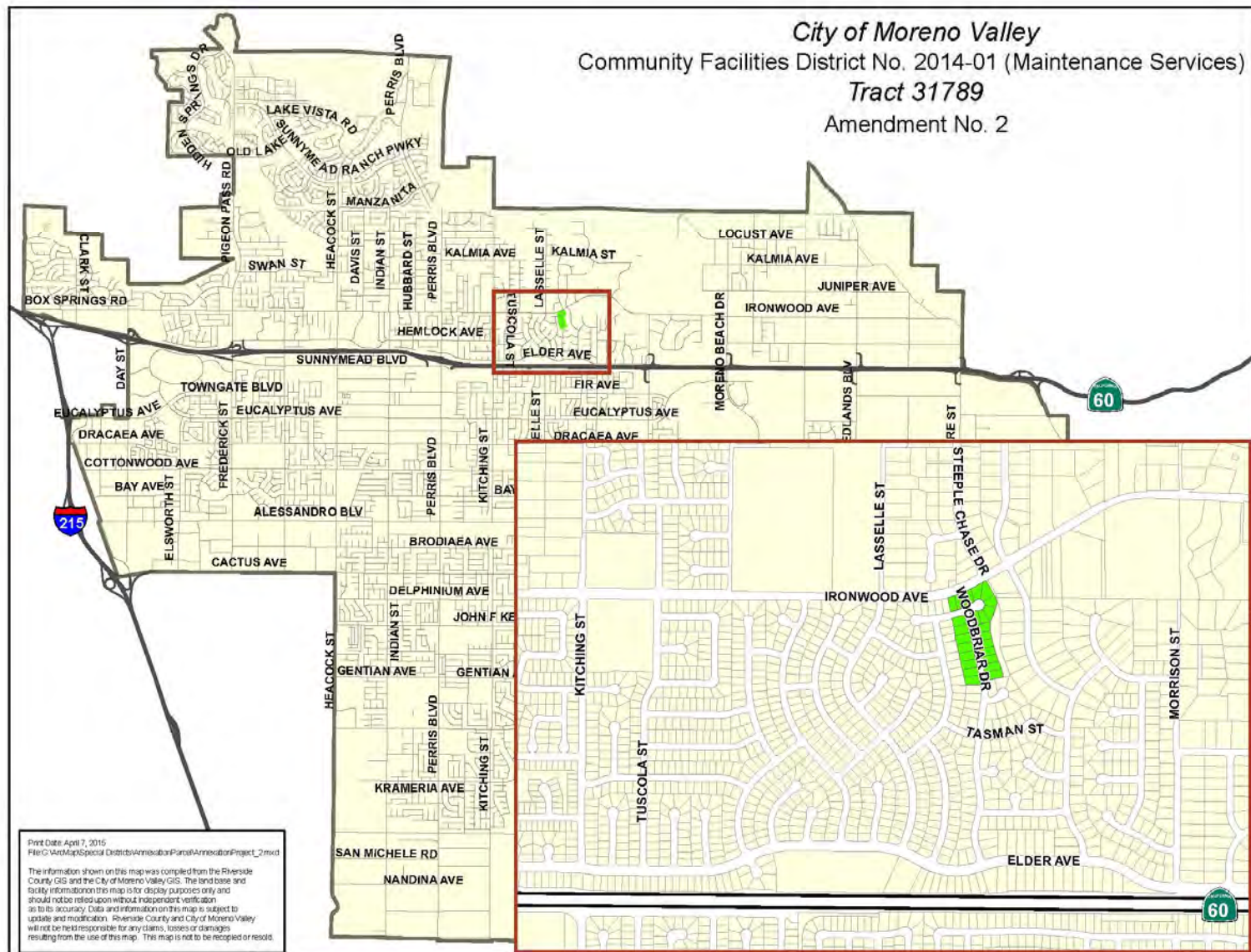

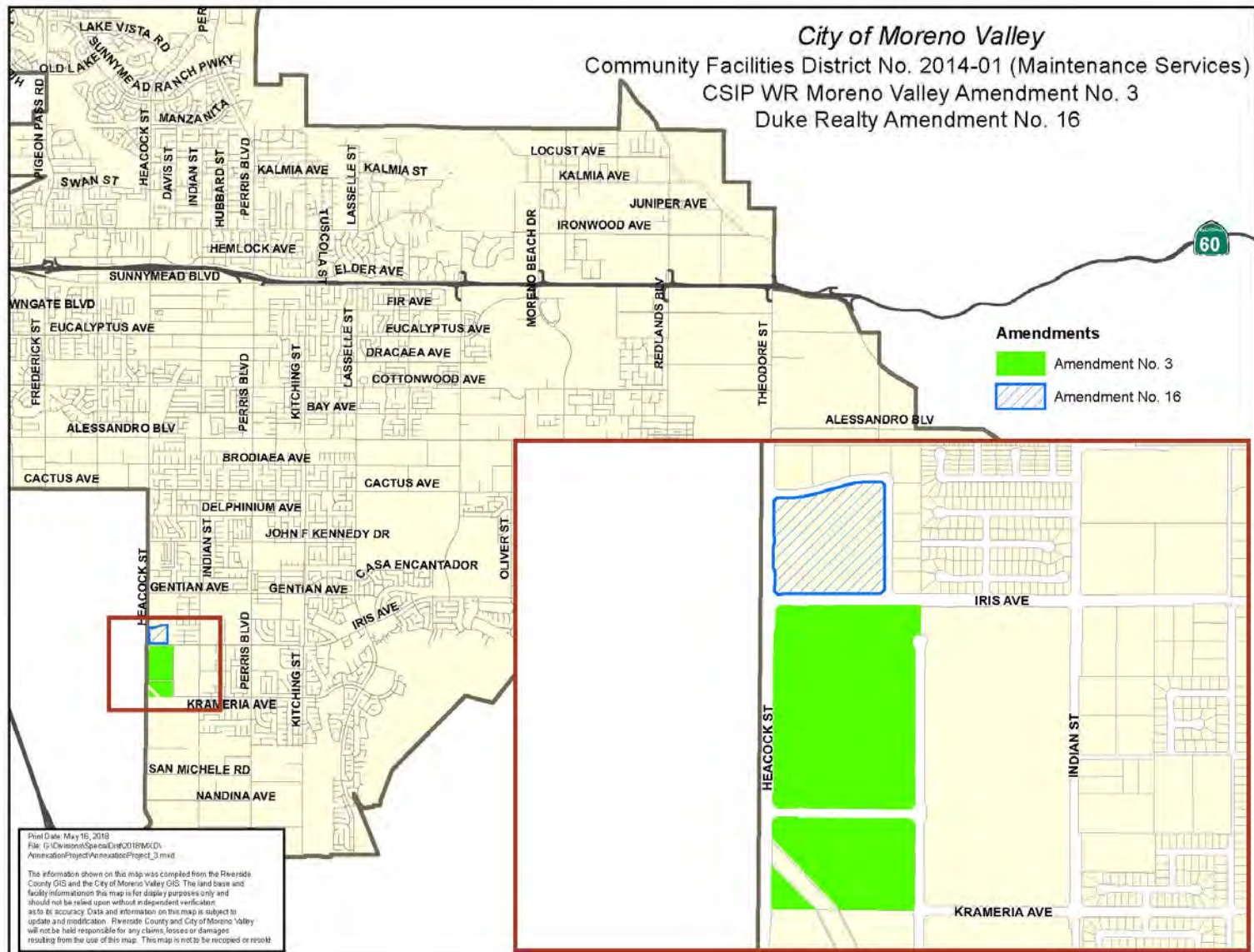

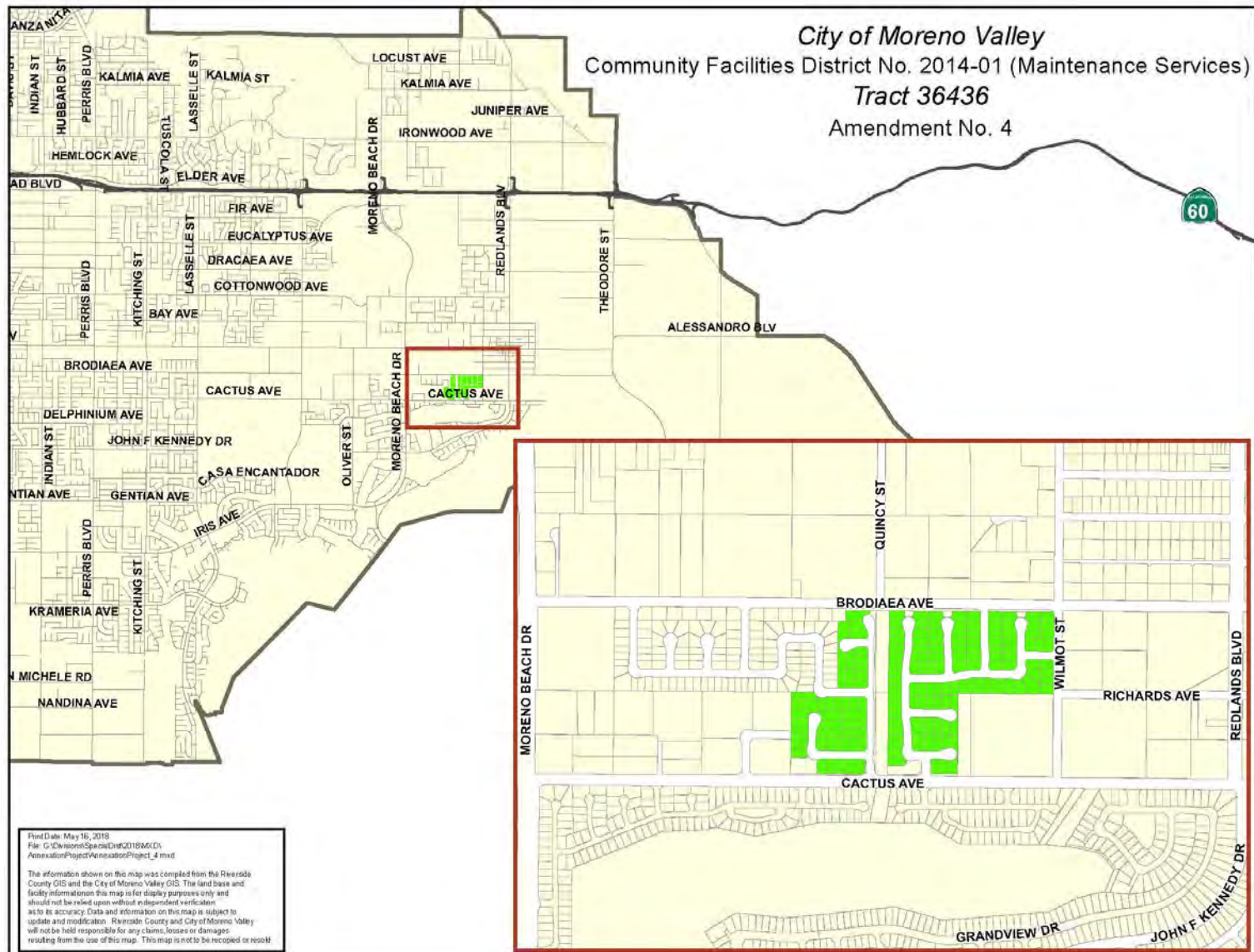

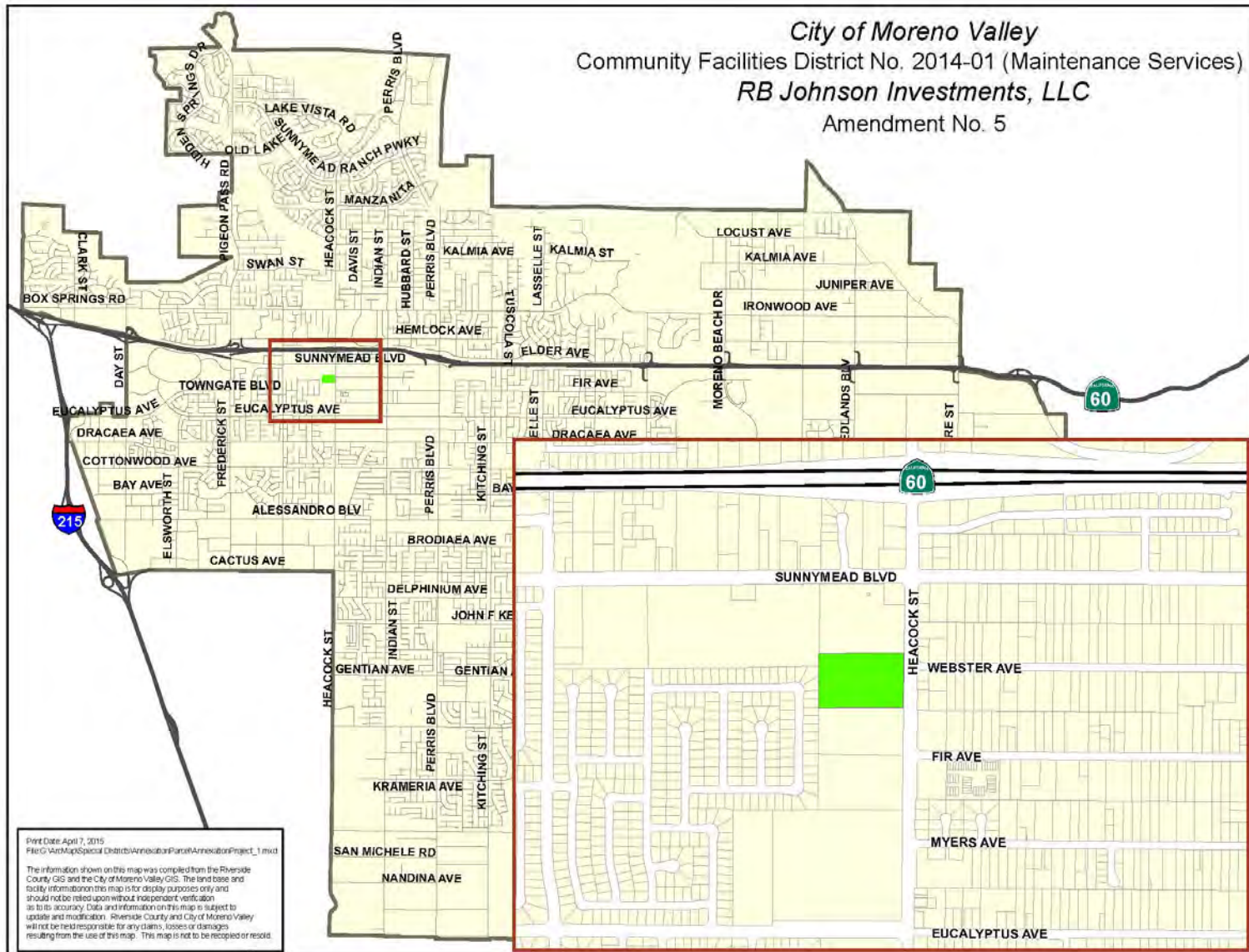

City of Moreno Valley
Community Facilities District No. 2014-01 (Maintenance Services)
Les Schwab Tire Center
Amendment No. 6

Print Date: April 27, 2016
File: G:\VroMap\Special Districts\Amendment\Paras\AmendmentProject_6.mxd

The information shown on this map was compiled from the Riverside County GIS and the City of Moreno Valley GIS. The land base and facility information on this map is for display purposes only and should not be relied upon without independent verification as to its accuracy. Data and information on this map is subject to update and modification. Riverside County and City of Moreno Valley will not be held responsible for any claims, losses or damages resulting from the use of this map. This map is not to be recycled or resold.

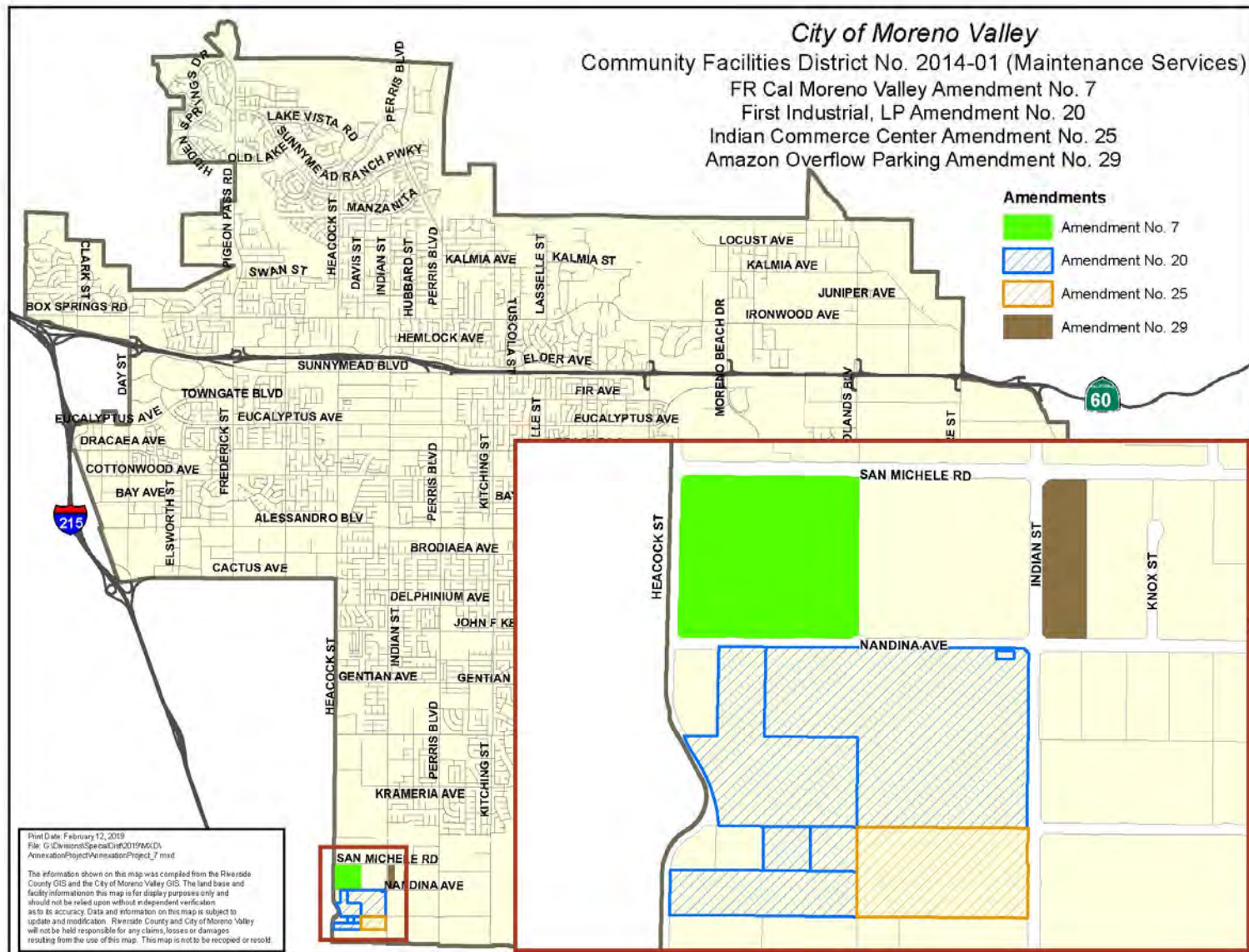

City of Moreno Valley
Community Facilities District No. 2014-01 (Maintenance Services)
Tract 31592
Amendment No. 8

Print Date: April 27, 2016
File: G:\ViroMap\Special Districts\Annexation\Paras\Annexation\Project_31.mxd

The information shown on this map was compiled from the Riverside County GIS and the City of Moreno Valley GIS. The land base and facility information on this map is for display purposes only and should not be relied upon without independent verification as to its accuracy. Data and information on this map is subject to update and modification. Riverside County and City of Moreno Valley will not be held responsible for any claims, losses or damages resulting from the use of this map. This map is not to be reprinted or resold.

